

DinaBase⁷

Reproduction prohibited: text and drawings are exclusive property of Pasini Chemical Laboratory S.n.c. All rights reserved.

Instructions for application

IMPORTANT: this product **IS NOT a conventional adhesive**. Its purpose is to **add a soft layer over the surface** of the dentures.

To obtain an optimal result, you **should understand** its **particular characteristics**, which are **completely different** from a normal dental cream, and **learn how to use it**.

DinaBase⁷ provides exclusive **"suction effect"** by **keeping the dentures stable**: adapting them to the mouth, thus avoiding pain and friction.

Important note: to stabilise the dentures, the **soft layer** of product on the surface has to adhere to the **mucous, (gums or palate)**. If the **thickness** of the gum is **too thin**, or if the **bone is exposed**, the **suction effect is not possible**: consequently, **adhesion is not guaranteed**.

With DinaBase⁷, the **dentures are perfectly close fitting** and **remain stable and comfortable** for several days. It is a thermoplastic material which softens when warmed, hardens when cooled: to ease application, it **has to be fluidized**.

1 Before use, **warm up** the tube; **do not open** the seal of the tube; **completely immerse** it, for a few minutes, in **warm, not boiling water**, at 60 °C max. While the tube is warming up, **remove all the residues** of any previously applied adhesives from the dentures. Carefully **brush and clean** the entire surface with soap, rinse with water and **dry thoroughly**. Make sure the **dentures are perfectly clean and dry before** applying

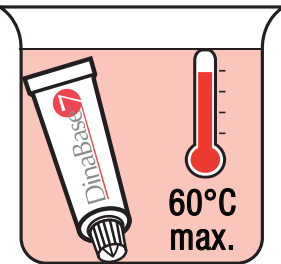

DinaBase⁷: **water, saliva or traces of food prevent it from adhering perfectly** to the dentures.

2 Take the tube, and **dry it well**. **Fully pierce the seal** with the pointed tip of the cap.

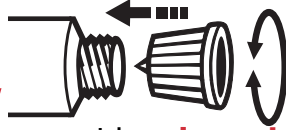

A **large round hole** has to be formed, to **fully open the flow section**: it must be **pierced open completely**, so that the product will come out of the tube easily.

ATTENTION: If the product does not flow freely, **first check to ensure** that the seal **has been pierced all the way through**. Repeat point 1 if the material does not come out because it is still too viscous (i. e. "hard").

NOTE. Attention, if the tube **has already been opened**, it must be **warmed with the cap**: screw it on again, and make sure it is **screwed on tight**.

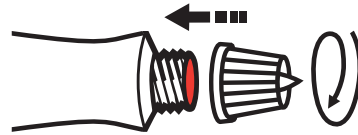

3 Press the tube near the fold, so that a ball of product, no less than the **size of a big cherry**, comes out.



4

Use a generous amount of product; place the ball in the centre of the upper dentures.

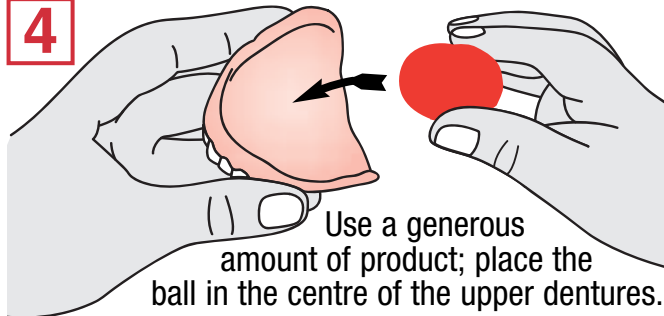

5 Use both thumbs to press and mould the material,

and spread a uniform layer over the entire surface of the dentures.

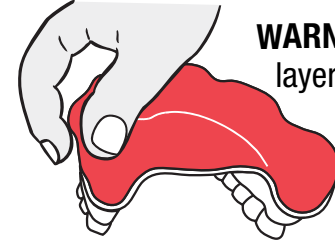
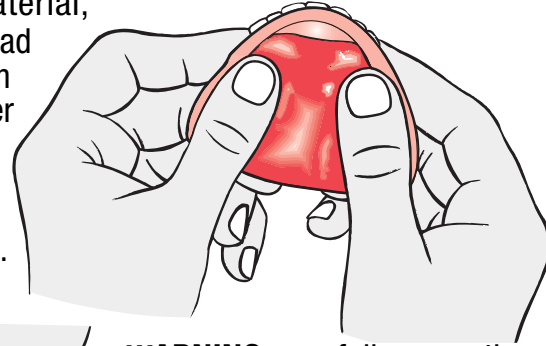

WARNING: carefully press the layer along the borders of the dentures: it must adhere well, to ensure a perfect suction effect.

6 **Wet your mouth well before** putting on the dentures. When they are in position, close your teeth and move your lips vigorously. The dentures will adapt correctly, and any excess material will spread outside the borders.



Note: if you experience a burning sensation when you put the dentures in your mouth, do not worry: a mild disinfectant action occurs on the first application. Remove the dentures and put them under **cold running water** for a few minutes. Rinse your mouth again before putting on the dentures: in this way the burning sensation will disappear.

7 Cut away the excess that has spread outside the borders of the dentures: first **put them under cold running water for a few minutes**. Then trim the edge with a small pair of scissors: your dentures are ready for use.

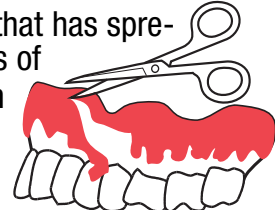

Very important notes:

Wash your hands thoroughly before moulding and applying the ball, to ensure that the product adheres correctly to the dentures.

Before applying DinaBase®7, the dentures must be perfectly clean: wash them carefully with soap, rinse with water, and dry them thoroughly.

The product will not come out of the tube easily if it has not been opened completely: a large round hole must be pierced, using the pointed tip of the cap. If it still does not flow, the tube has not been warmed enough: screw the cap back on firmly, and repeat the warming process as described in point 1 overleaf.

Perfect for lower dentures too

For the lower dentures, follow the method as described in points 1, 2 and 3 overleaf.

Once you have obtained the ball, mould it with your fingers into a small sausage-like shape, and then press it into the groove of the dentures;

adapt the material and spread it with your thumbs until it covers the entire surface.

Make sure the material adheres well along the borders, too, and do not exceed with the quantity.

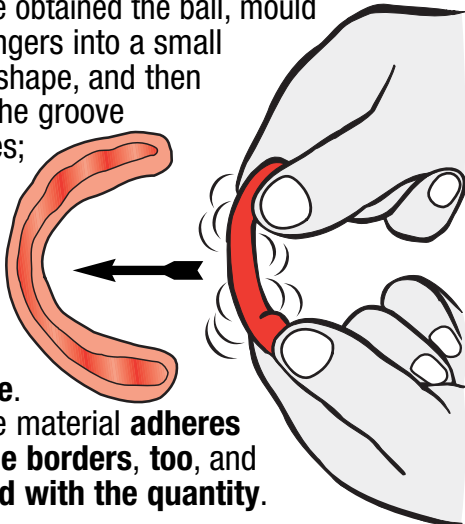

Recommendations and advice

- Avoid alcohol and very hot drinks during the first few hours after application.
- If you realize that the quantity applied is not enough, then you can easily add more material; but first clean the entire surface of the layer carefully, and dry it thoroughly: only in this way will the addition adhere well.

After the first applications, you will be able to understand how much material to use and how to distribute it. You will know where to leave more overlapping material to prevent food from getting under the dentures, and where to distribute less material to avoid unwanted friction.

If the product is applied correctly, the dentures will be positioned comfortably and no infiltration of food will occur. One application lasts for 7 days.

How to clean and preserve the dentures

On the first day of application, simply rinse the dentures with cold water and very delicately brush them with a normal toothbrush. From the second day onwards, brush in the normal way.

You can also use denture cleaning tablets so long as their action is rapid (5 to 10 minutes).

Do not soak the dentures longer than the time indicated for the tablets to act; then put them, dry, in their case. In the morning, before wearing them, soak them for a few minutes in warm water, to soften the surface layer of DinaBase®7.

When to replace DinaBase®7

Replace DinaBase®7 every 7 days, to guarantee the maximum level of hygiene and to avoid the colonisation of bacteria or fungi and the onset of halitosis. The ingredients of the product have been specifically selected to ensure that the formula is fully compatible with acrylic dentures.

Warning and precautions

DinaBase®7 has been used by dentists for years, and there have been no reports of any cases of adverse reactions. You should however contact your dentist if you think that the product may be unsuitable for you. Do not use it if you suffer from ALLERGIES or if you have hypersensitivity to its ingredients, in particular to Ethyl Alcohol (Ethanol). By placing an adequate thickness of material over the surface, in some cases it may be possible to insert the dentures even over a suture.

REF Printed on the outer packaging.

How to remove DinaBase®7

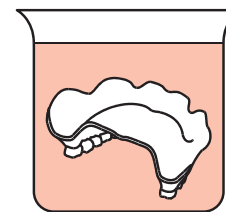

Immerse the dentures in warm water (60°C) for at least 5 to 10 minutes.

Then raise and peel off the entire layer of old material. Use only a blunt instrument, such as a teaspoon, to avoid scratching the dentures.

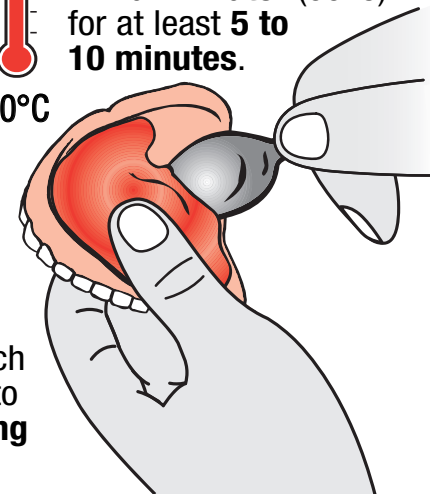

Storage: the contents of the tube are sufficient for more than one application. Take the required amount of product; immediately afterwards screw the cap tightly again onto the tube. Keep it, tightly closed, in a cool place.

MEDICAL DEVICE

Composition: highly viscous solution of Polyvinyl Acetate in Ethanol.



DinaBase®7 is manufactured by:
Dr. Pasini Laboratorio Chimico
S.n.c. - Via dell'Industria, 5

20875 Burago Molgora (Monza e Brianza), Italy

Italian product

Conceived and manufactured entirely in Italy.

EN Revision 04, 03-2024

Exclusive distribution is by:
QuattroTi DenTech S.r.l.

Via Maestri del Lavoro, 120
21040 Cislago (Varese) - Italy
e-mail: info@quattroti.com



SALES: Arando OHG; **WEB:** arando-online.co.uk
e-mail: office@arando-online.de